

# Portable Triple Screen Laptop Workstation

## Packing List

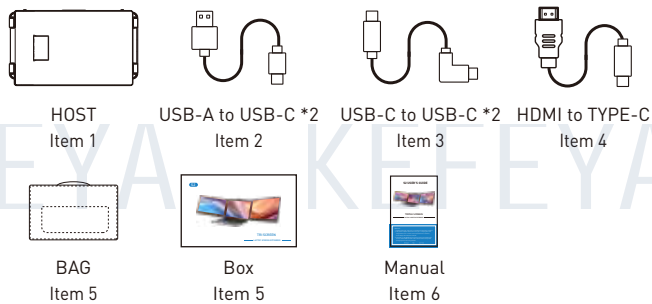

## These Ports You Need to Know

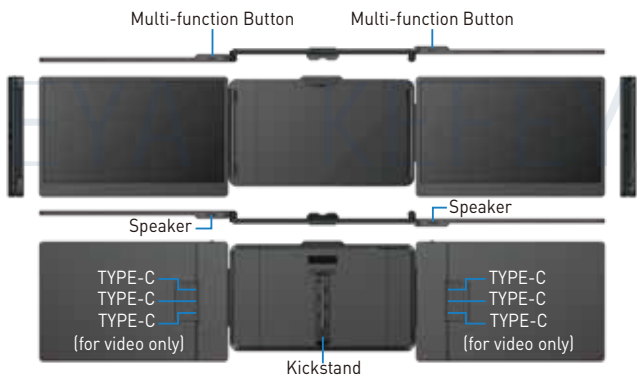

## Key Definitions

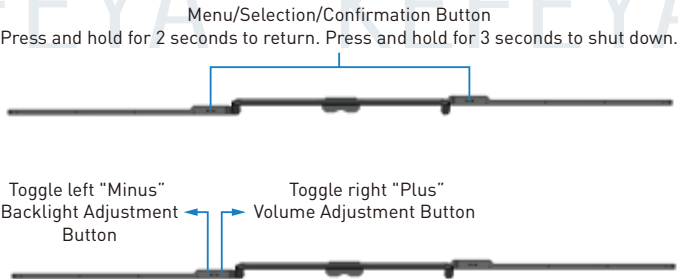

## Operation Steps

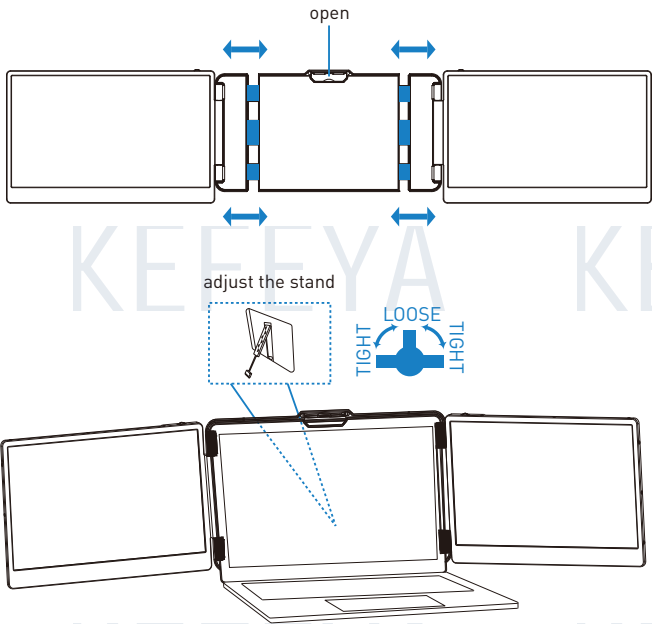

## How to Connect

**TYPE-C Connection:**

If your laptop has two full-featured Type-C ports, you can connect the S2 directly to your laptop with two Type-C cables.

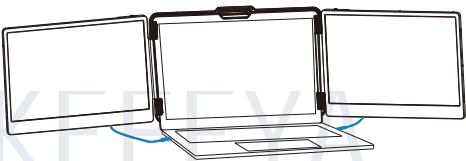

**Notice:**

If the display has no signal or the signal is unstable after connection, please connect an external 5V/2A power adapter to power the laptop.

**TYPE-C & HDMI & USB-A Connection:**

If your laptop has one full-featured Type-C port, one USB-A port and one HDMI port, please first connect one monitor using the USB-C cable. Then connect the other monitor using the USB-A to USB-C cable and the HDMI to Type-C cable.

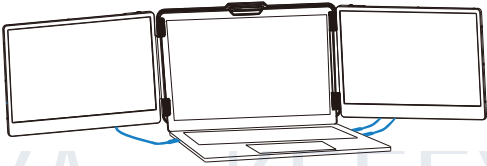

**Notice:**

If the display has no signal or the signal is unstable after connection, please connect an external 5V/2A power adapter to power the laptop.

## Q&A

**Q1: How can I tell if the USB-C port on my computer is full-featured?**

A1: A USB-C port with one of the following symbols is a full-featured one. Thunderbolt 3 or Thunderbolt 4 ports are also full-featured ports. You can view the port parameters in the manual or on the Web.



**Q2: Why does one monitor show "No Signal" ?**

A2: There may be a connection failure or the computer port does not support video output. Please contact us for troubleshooting. We will provide you with a solution as soon as possible!

**Q3: The screen does not light up after connecting?**

A3: It is possible that your computer does not have enough power. Please charge the monitor with an external power supply that provides 5V/2A power. You can also contact us for further solutions.

## Tips for Use

Please refer to the pictures below to plug and unplug the data cable to avoid damage.

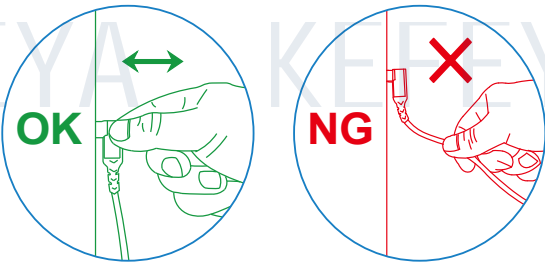

For more detailed information, please refer to the product brochure.